

MICROFILM ON WING AND STAB. Y2K ON REST
KEVLAR BRACING ON WING AND STAB

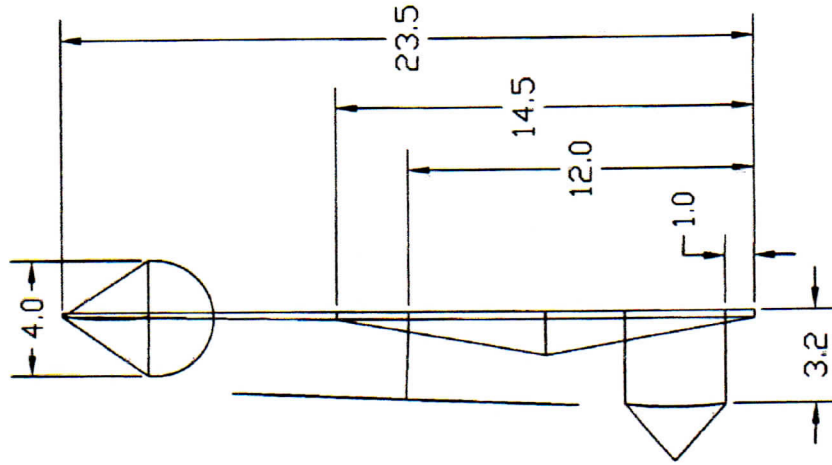

COMBINED WING AND STAB AREA = 130.8 SQ IN
50% OF COMBINED WING AND STAB AREA = 65.4 SQ IN
ROTOR MUST BE GREATER THAN 50% OF COMBINED WING AND STAB AREA
ROTOR AREA IS 72.7 SQ INCHES > 65.4 SQ INCHES

MOTOR: 125mg
WING: 178mg
STAB: 204mg
PROP: 123mg
STICK: 330mg
ROTOR: 184mg
TOTAL: 1019mg

ROTA

~~ALUMINUM CRYSTAL-DRUM~~
~~DIFFERENTIAL-DRUM~~

MOTOR: 125mg

MOTOR: 13.0" x 1-139R 302

1750-170 tundra

DESIGNED, BUILT, FLOWN AND DRAWN BY DON SLUSARCZYK

Autogiro

CAT II 4/28/8 15:37