

MICROFILM ON WING AND STAB. Y2K ON REST KEVLAR BRACING ON WING AND STAB

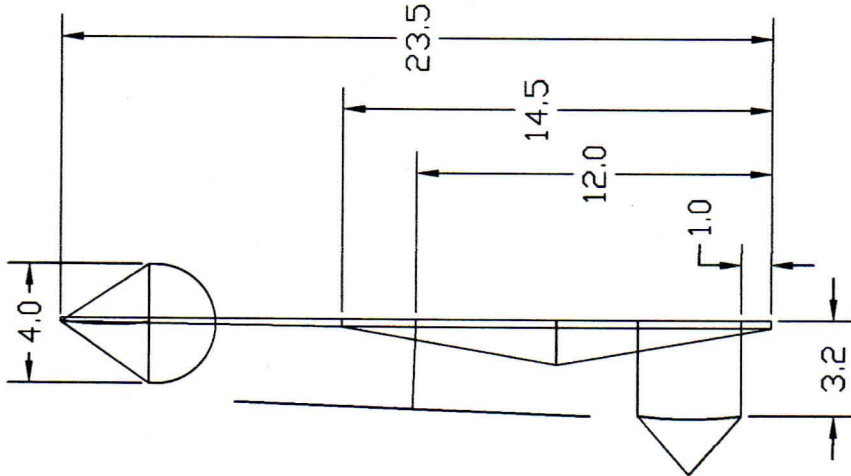

COMBINED WING AND STAB AREA = 130.8 SQ IN
 50% OF COMBINED WING AND STAB AREA = 65.4 SQ IN
 ROTOR MUST BE GREATER THAN 50% OF COMBINED WING AND STAB AREA
 ROTOR AREA IS 72.7 SQ INCHES > 65.4 SQ INCHES

- WING: 178mg
- STAB: 204mg
- PROP: 123mg
- STICK: 330mg
- ROTOR: 184mg
- TOTAL: 1019mg

MOTOR: 1.25gr X 16' LONG

ROTA

AUTOGYRO CAT III OPEN 2141
 DATE: 3/25/2017 WEST BADEN